

修改前

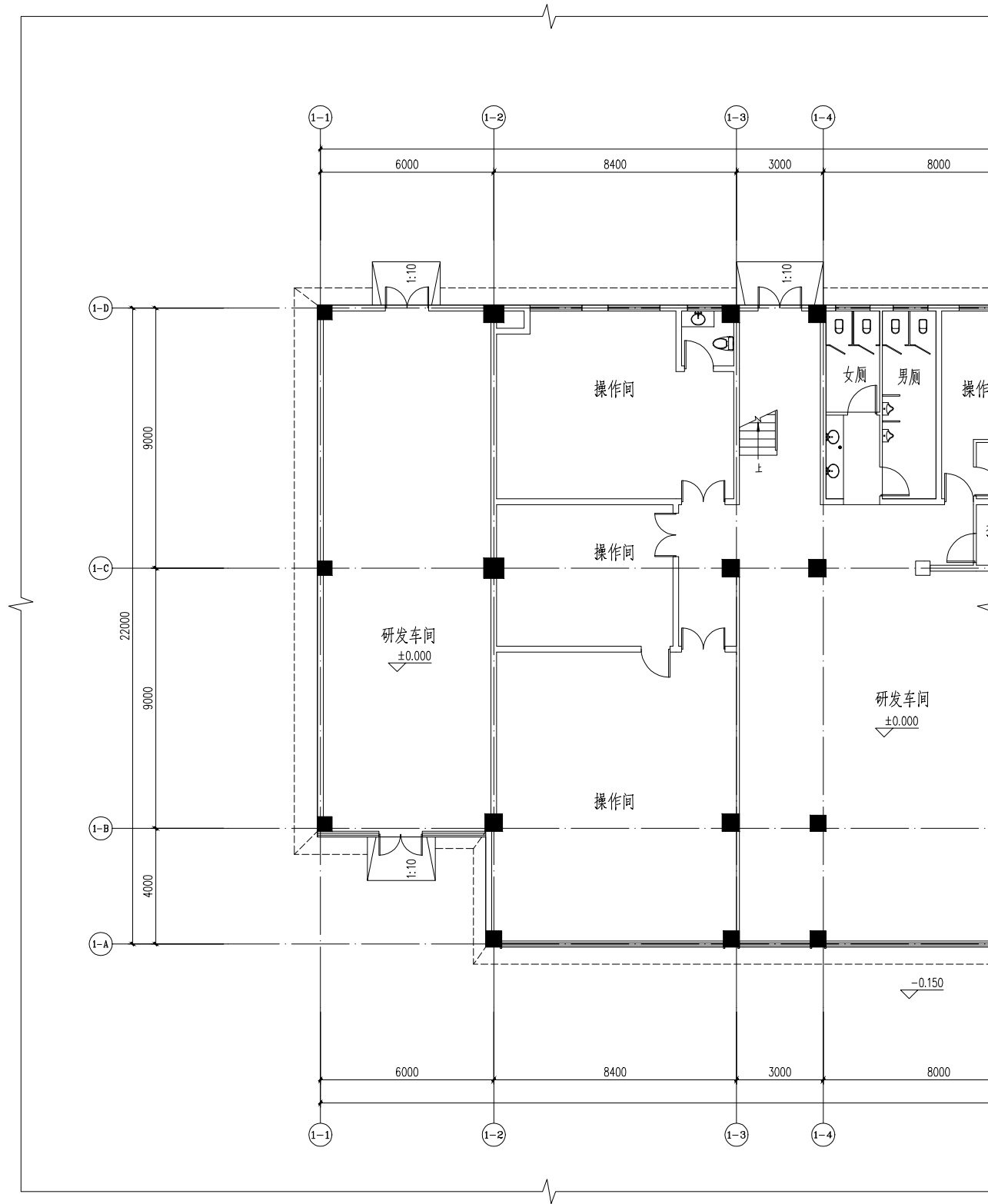

1-1#楼一层平面图 1:100

修改后

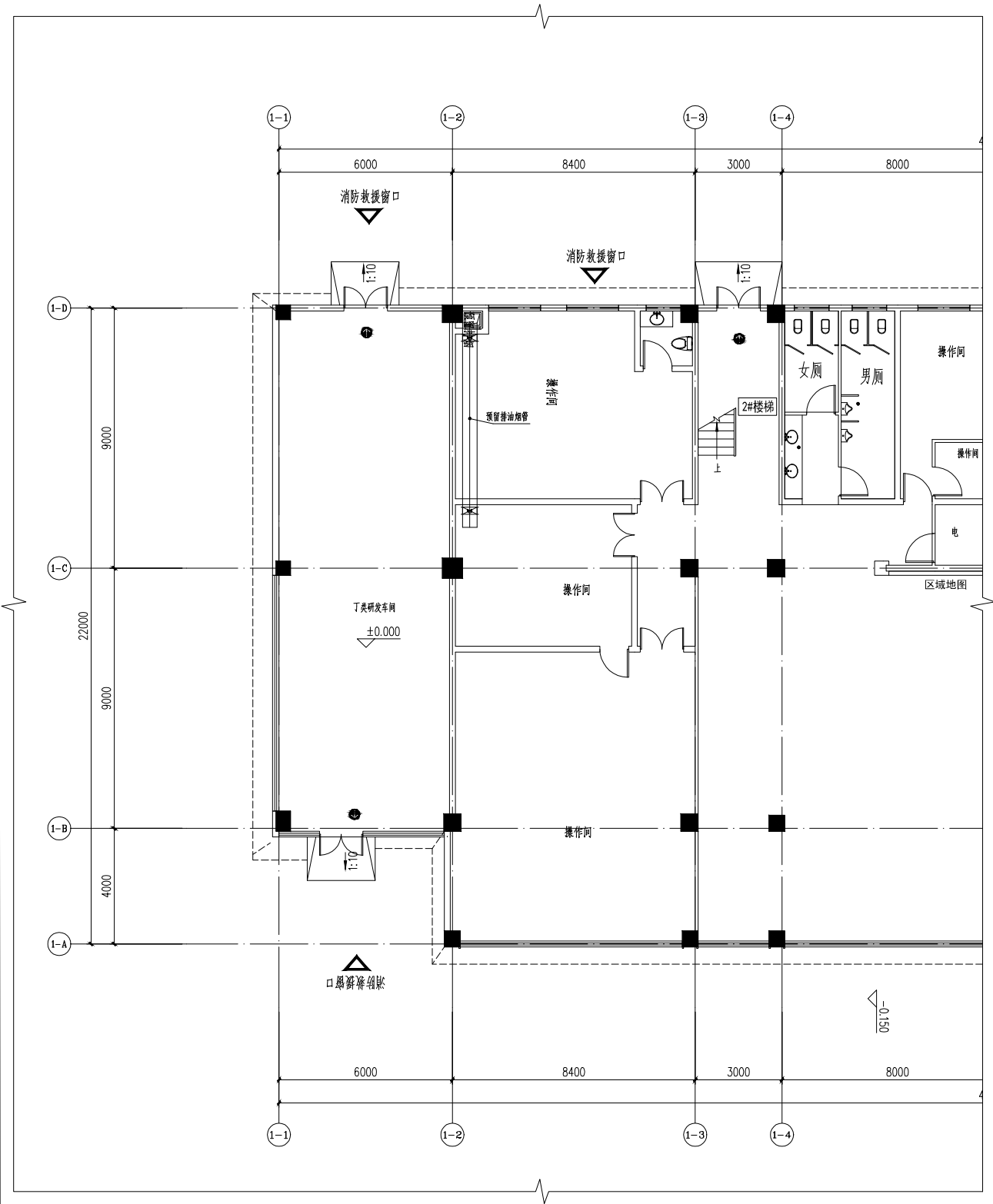

1-1#楼一层平面图 1:100

修改前

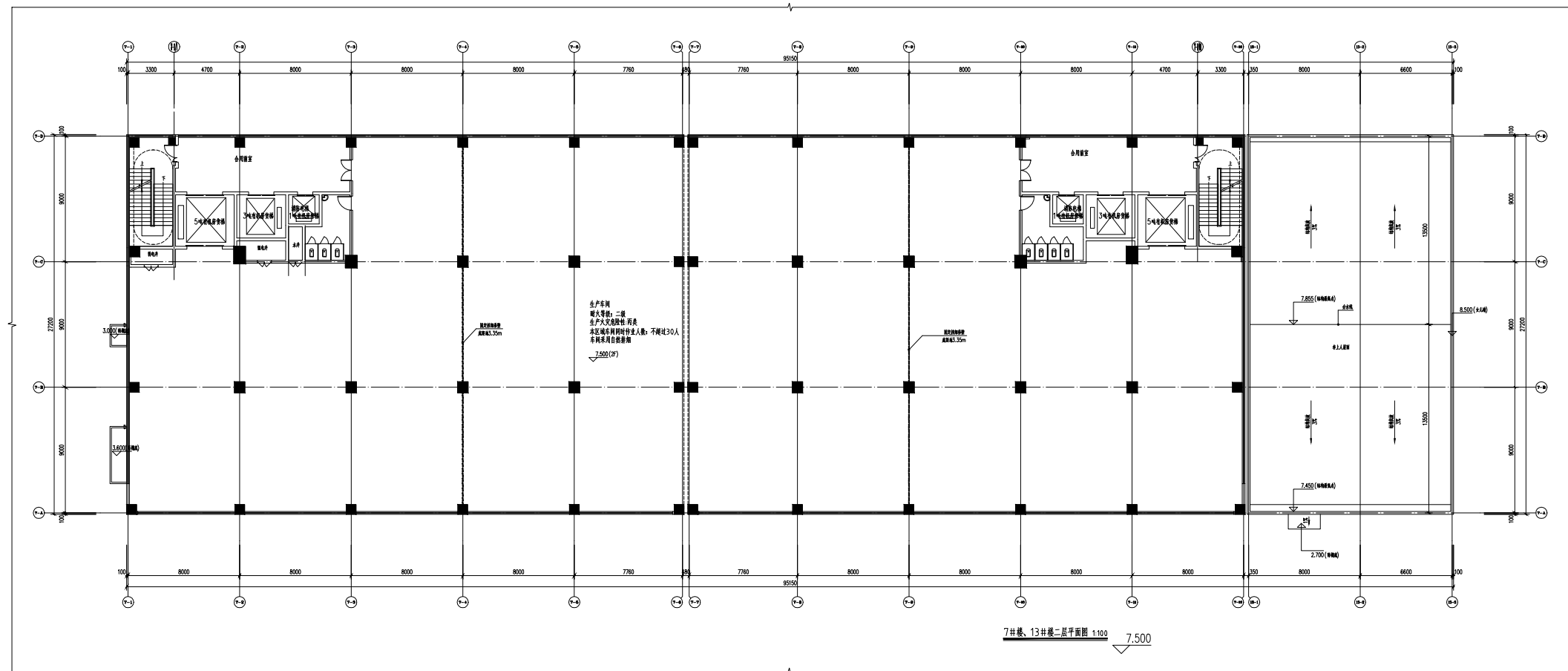

修改后

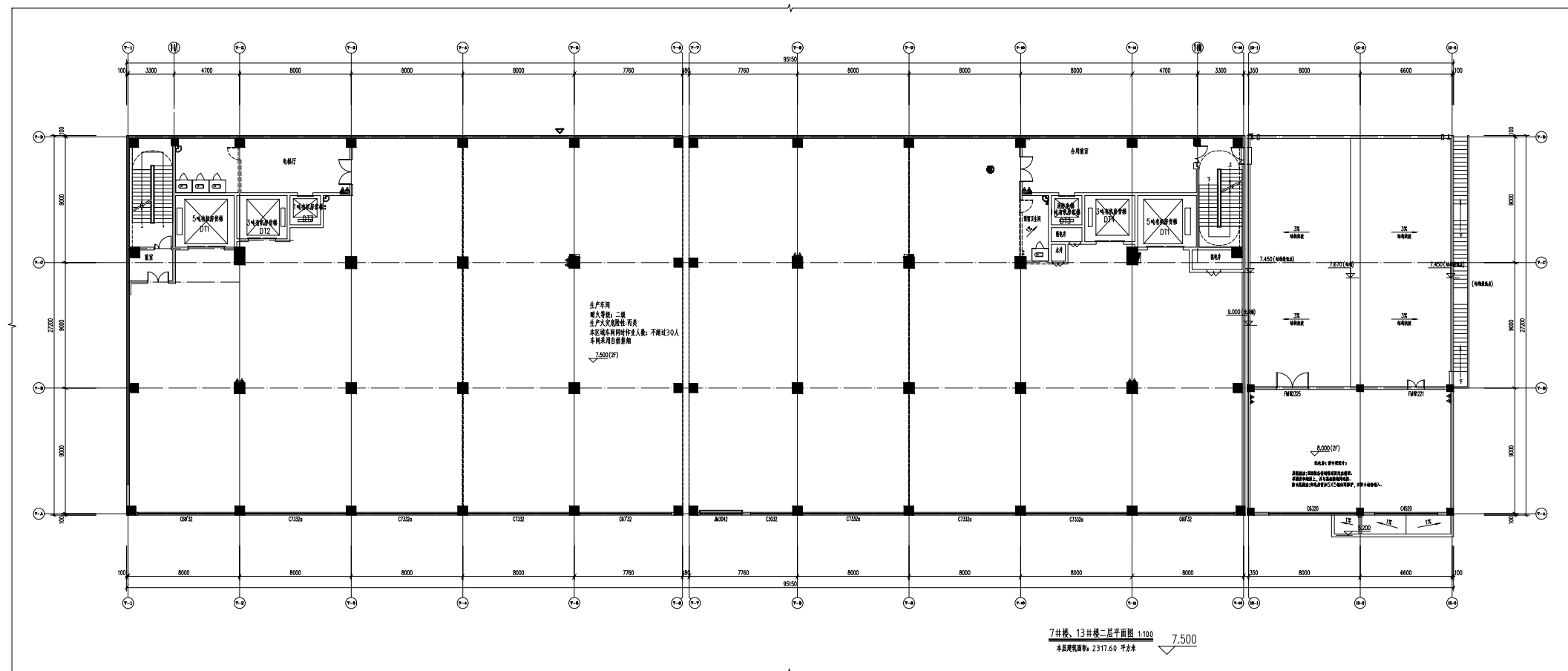

修改前

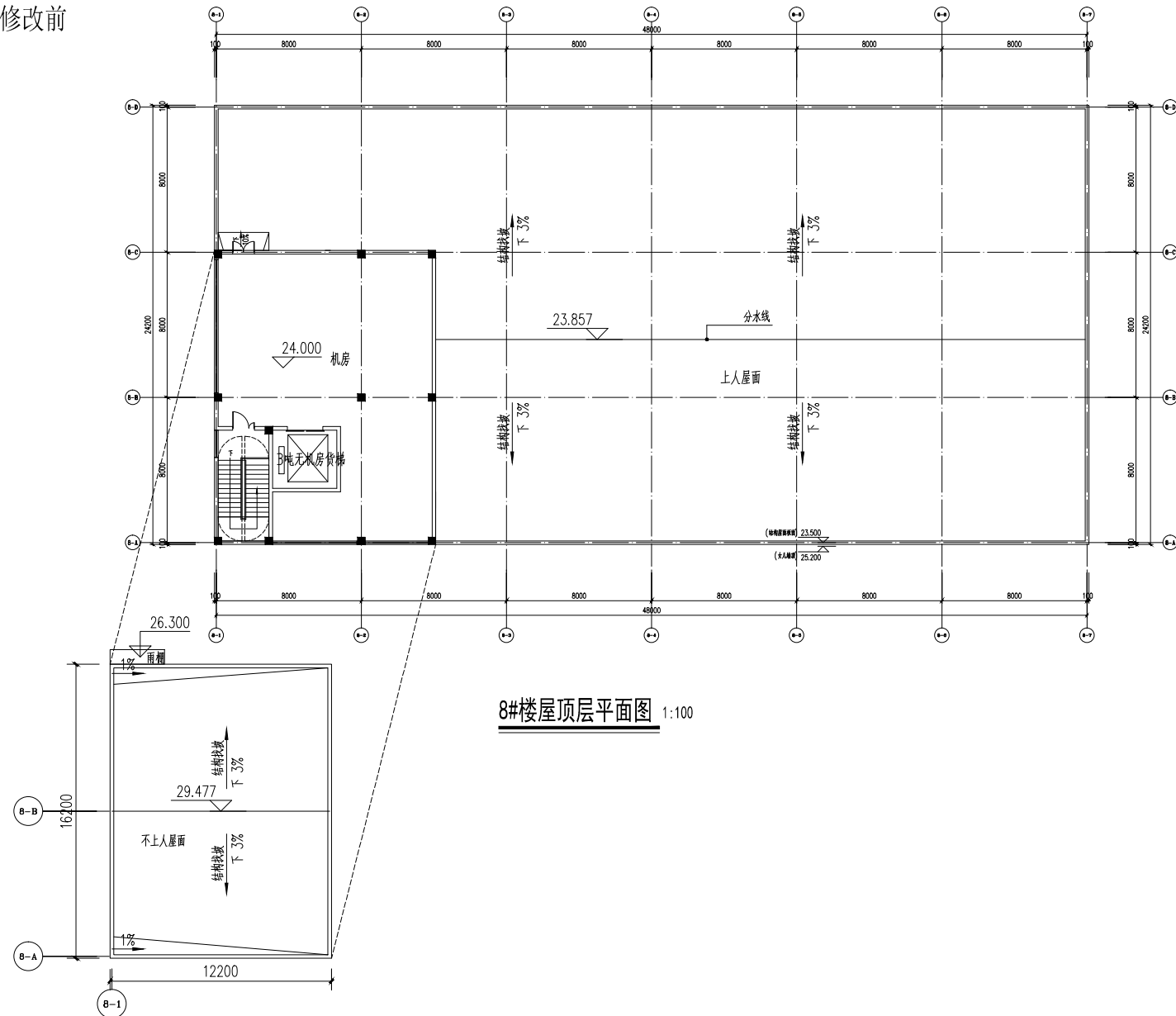

修改后

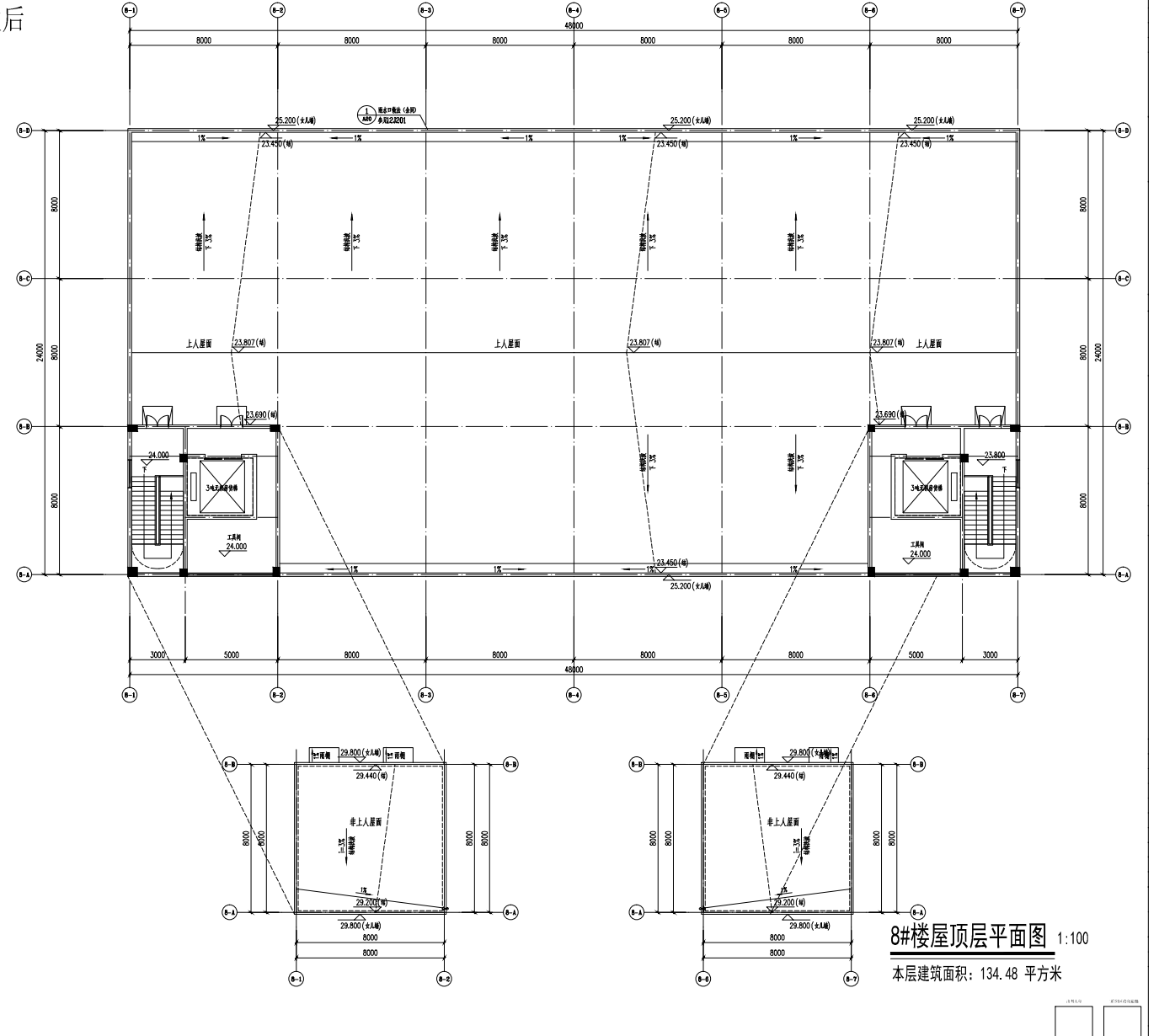

修改前

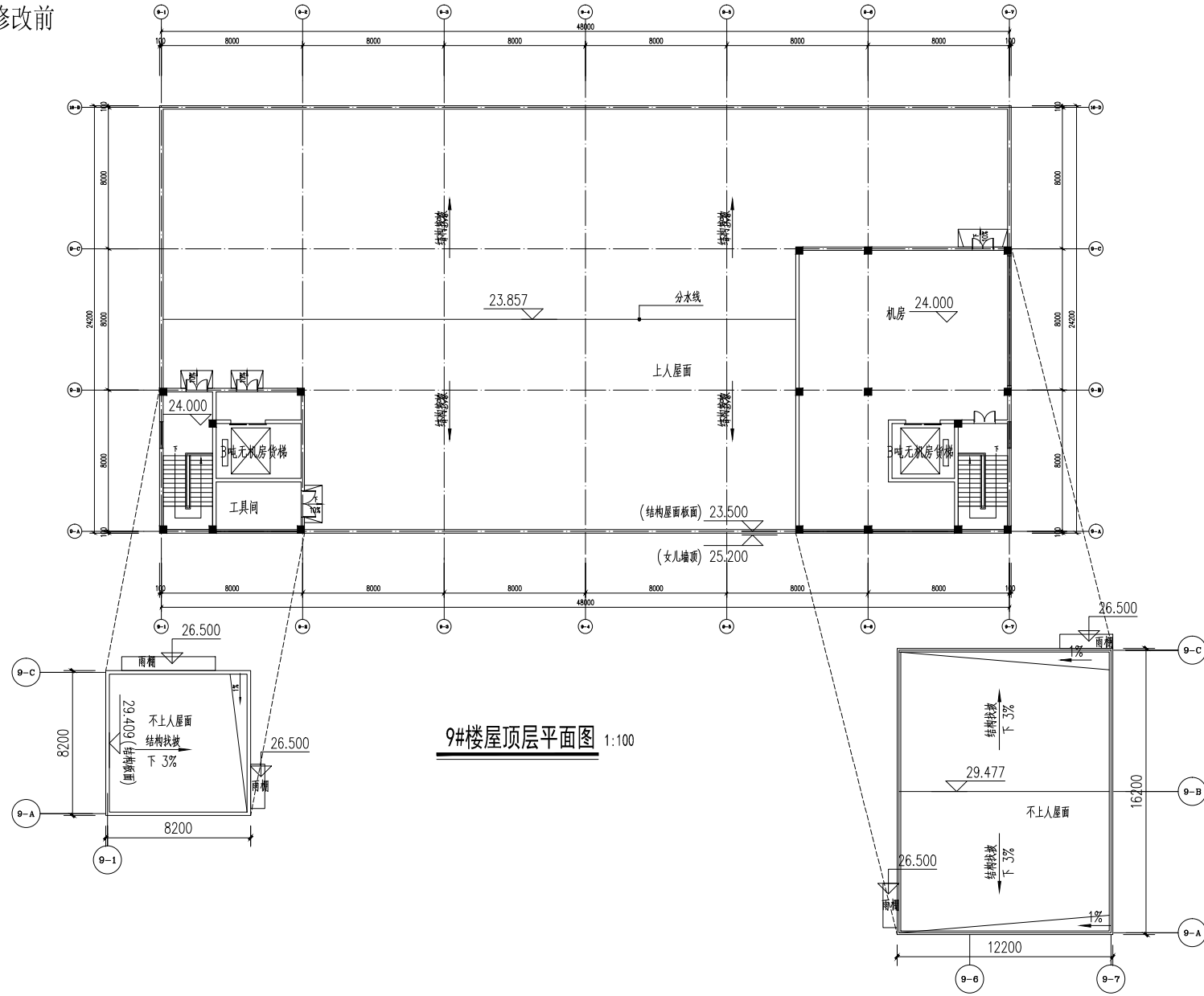

修改后

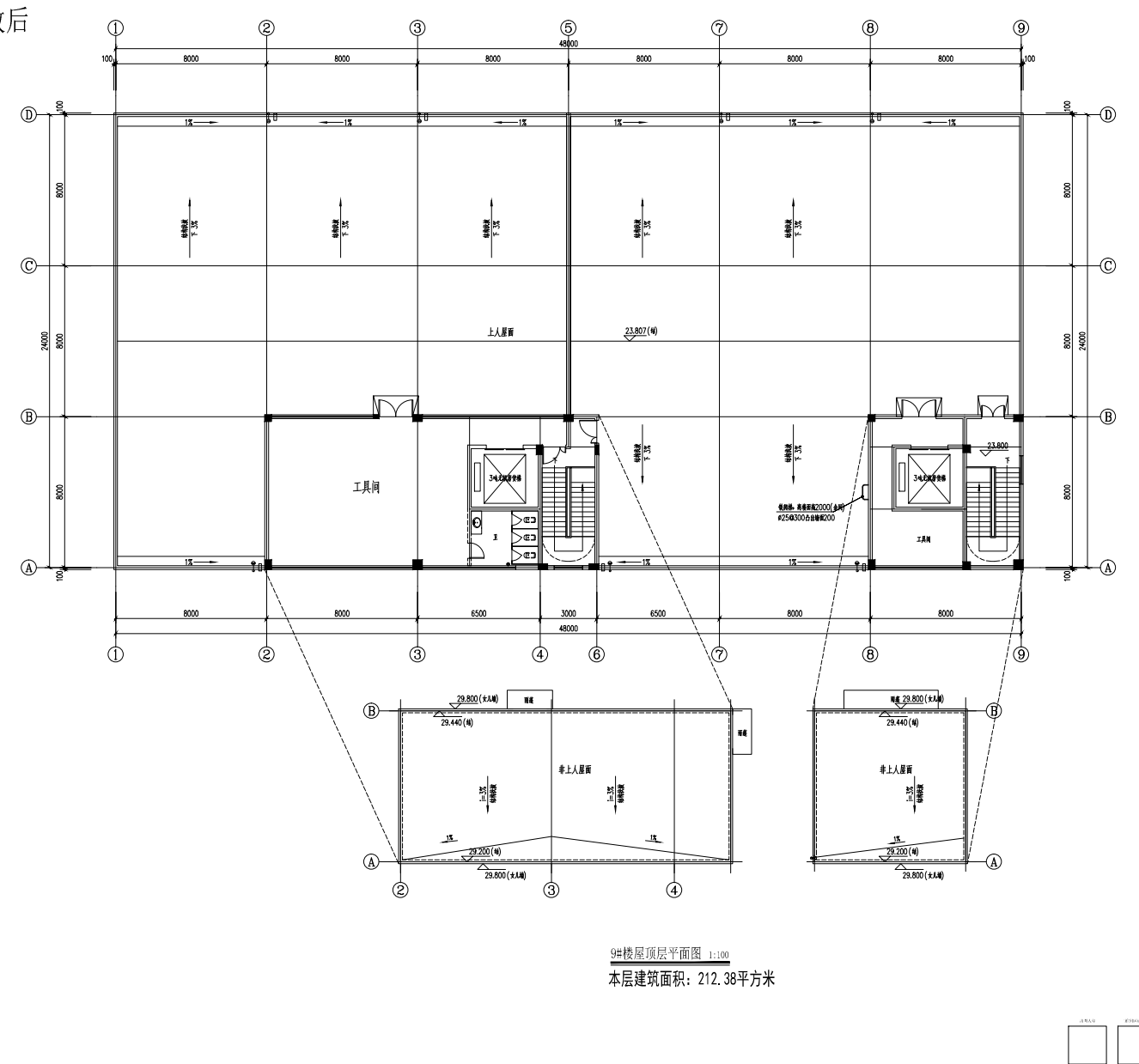

修改前

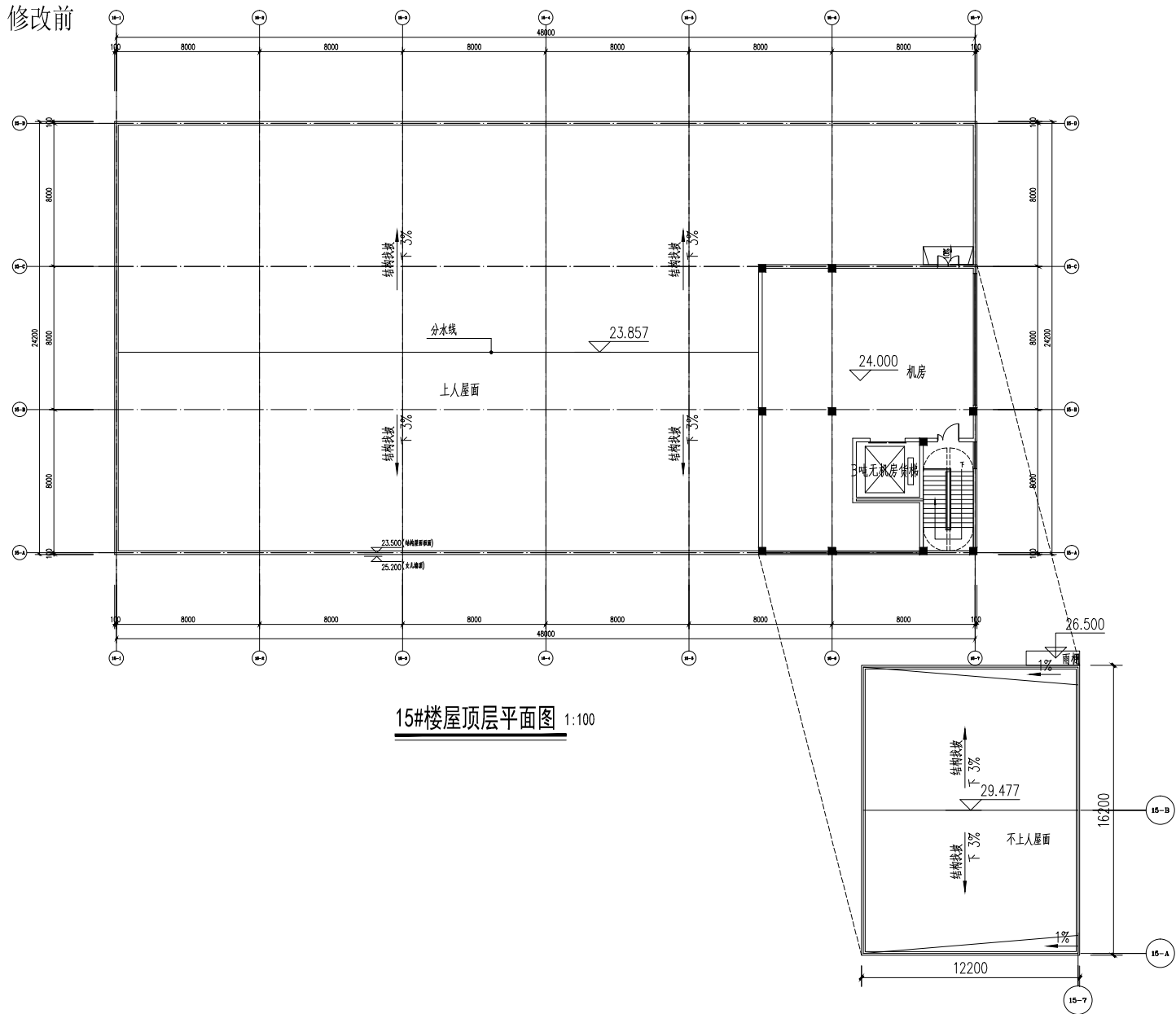

修改后

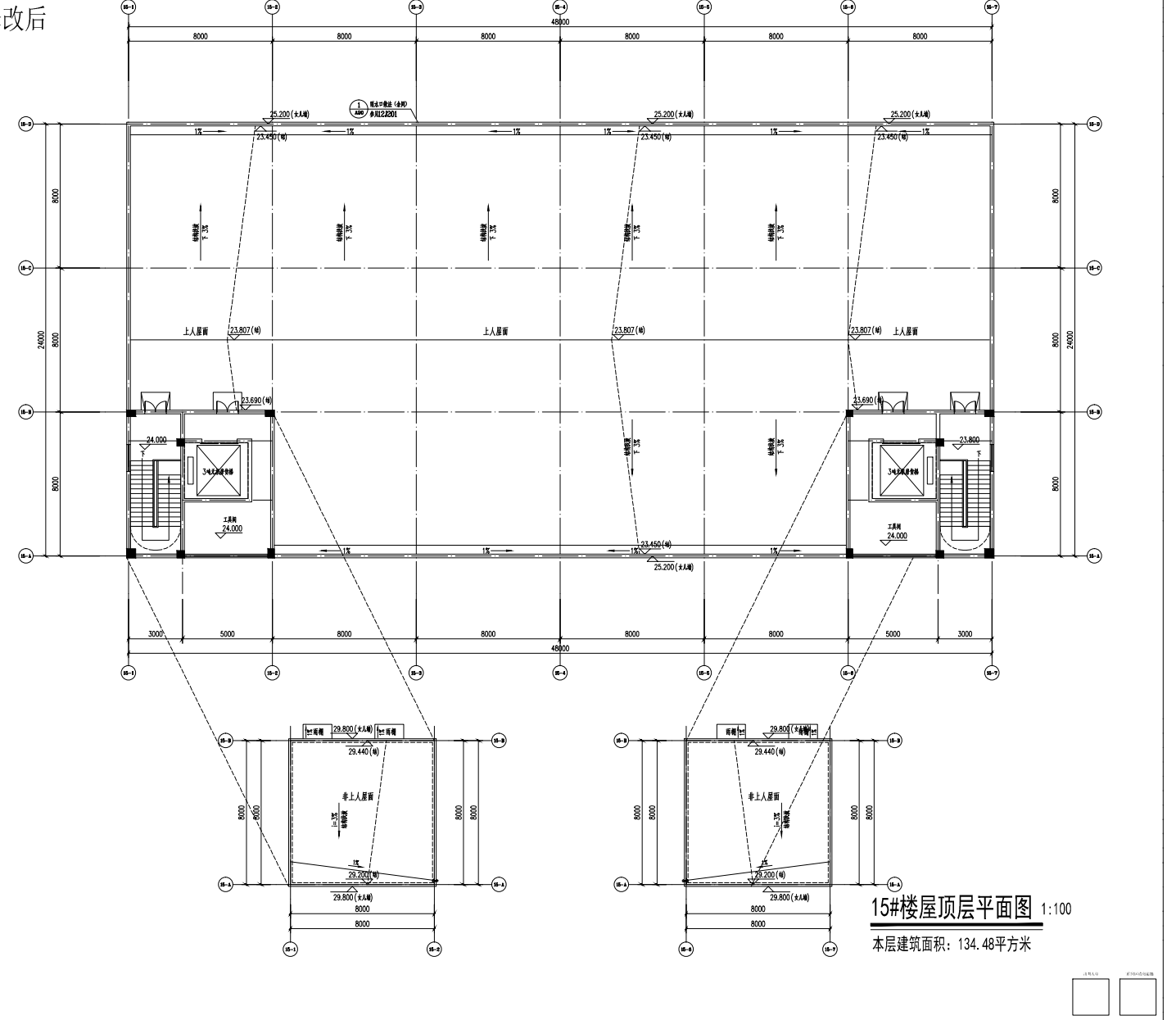

修改前

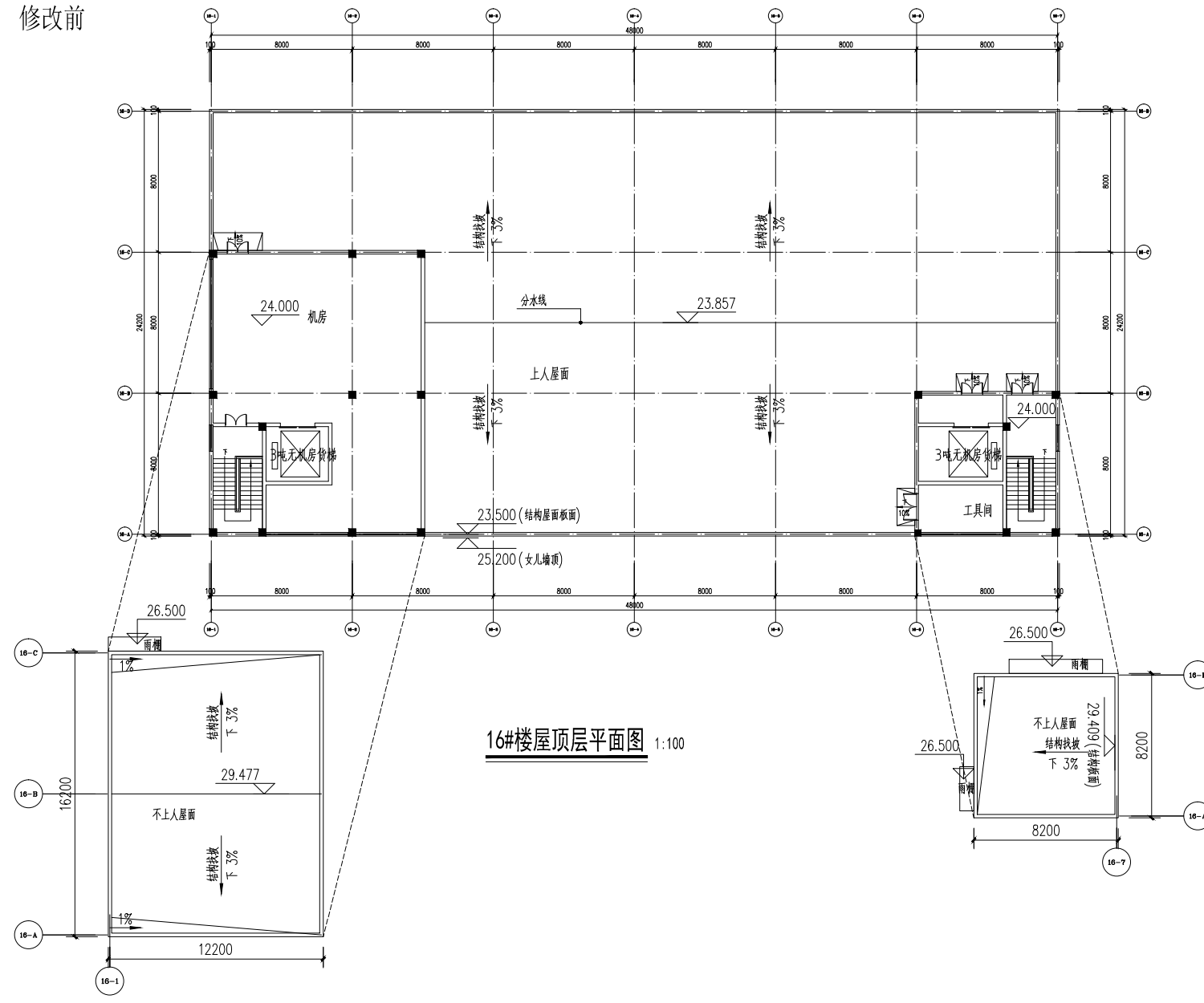

修改后

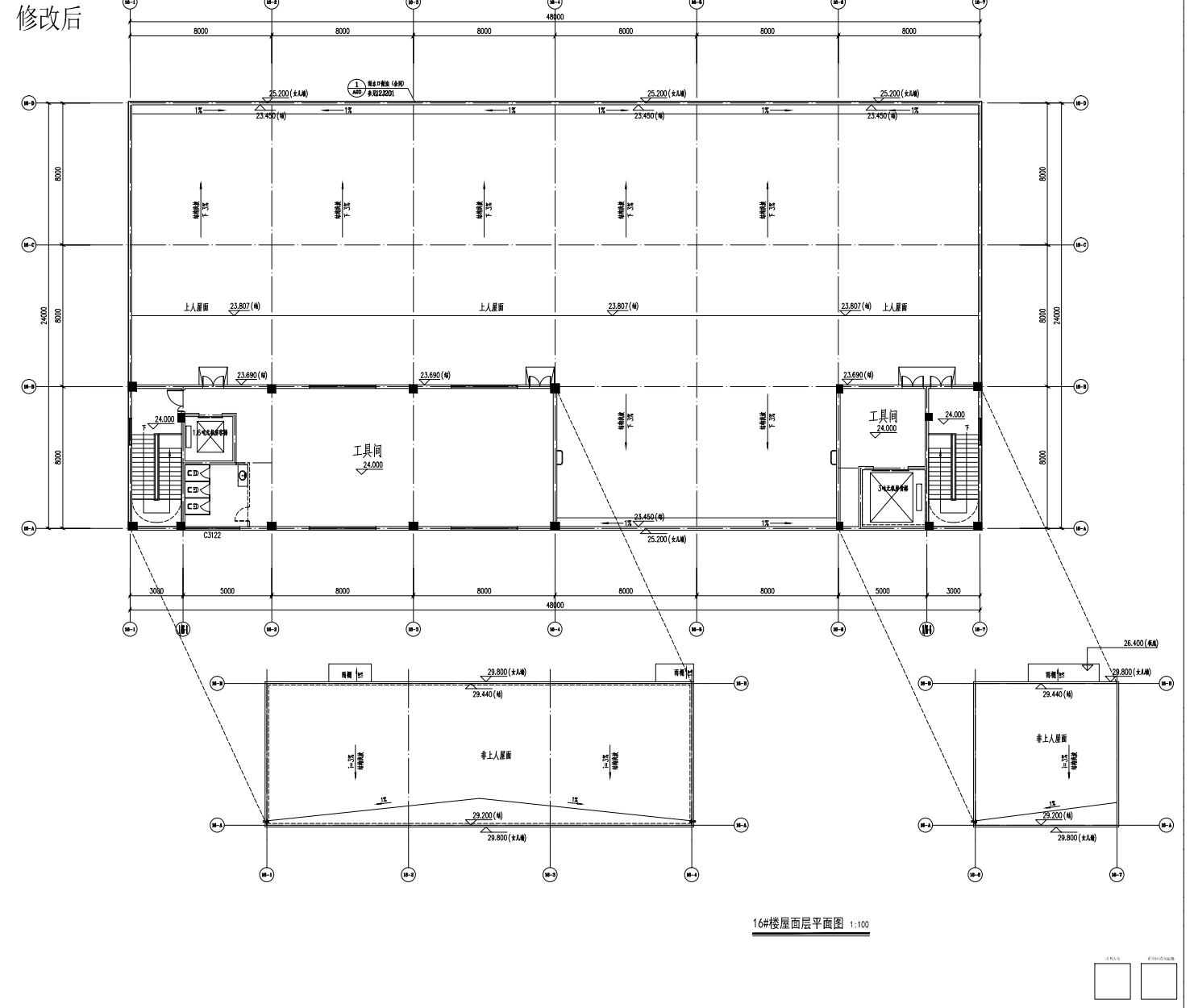

修改前

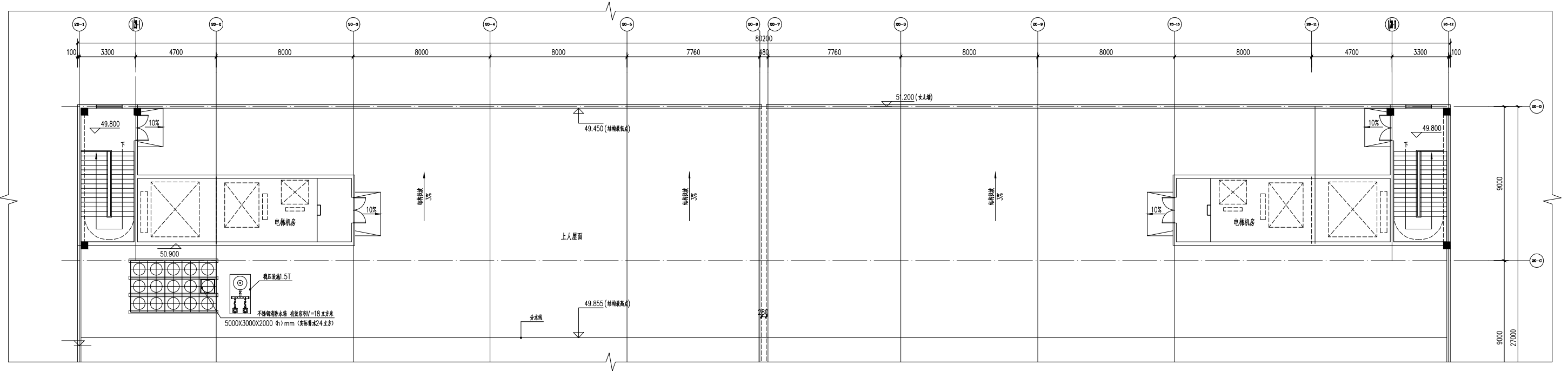

20#楼屋面层平面图 1:100

修改后

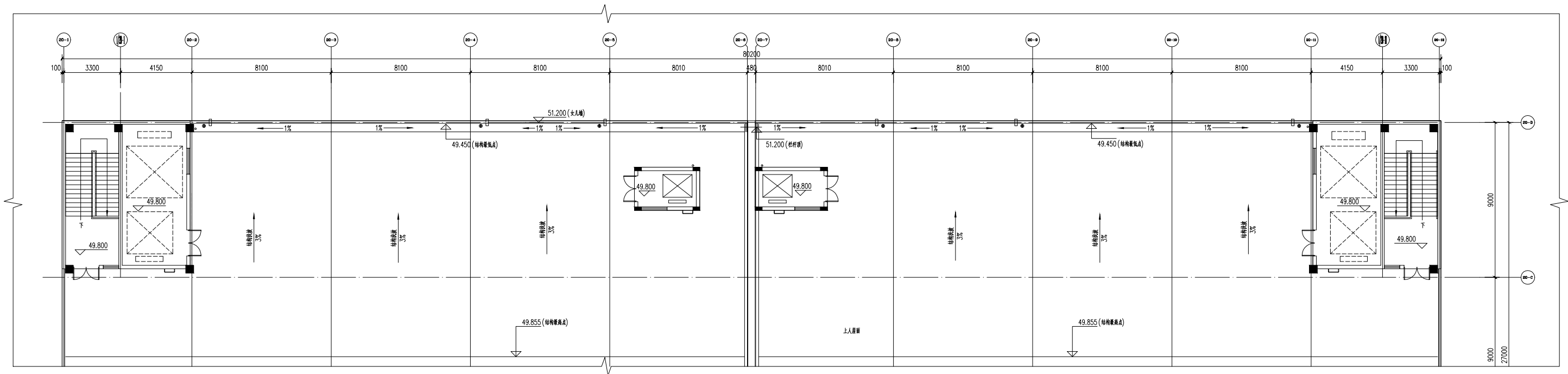

20#楼屋面层平面图 1:100

修改前

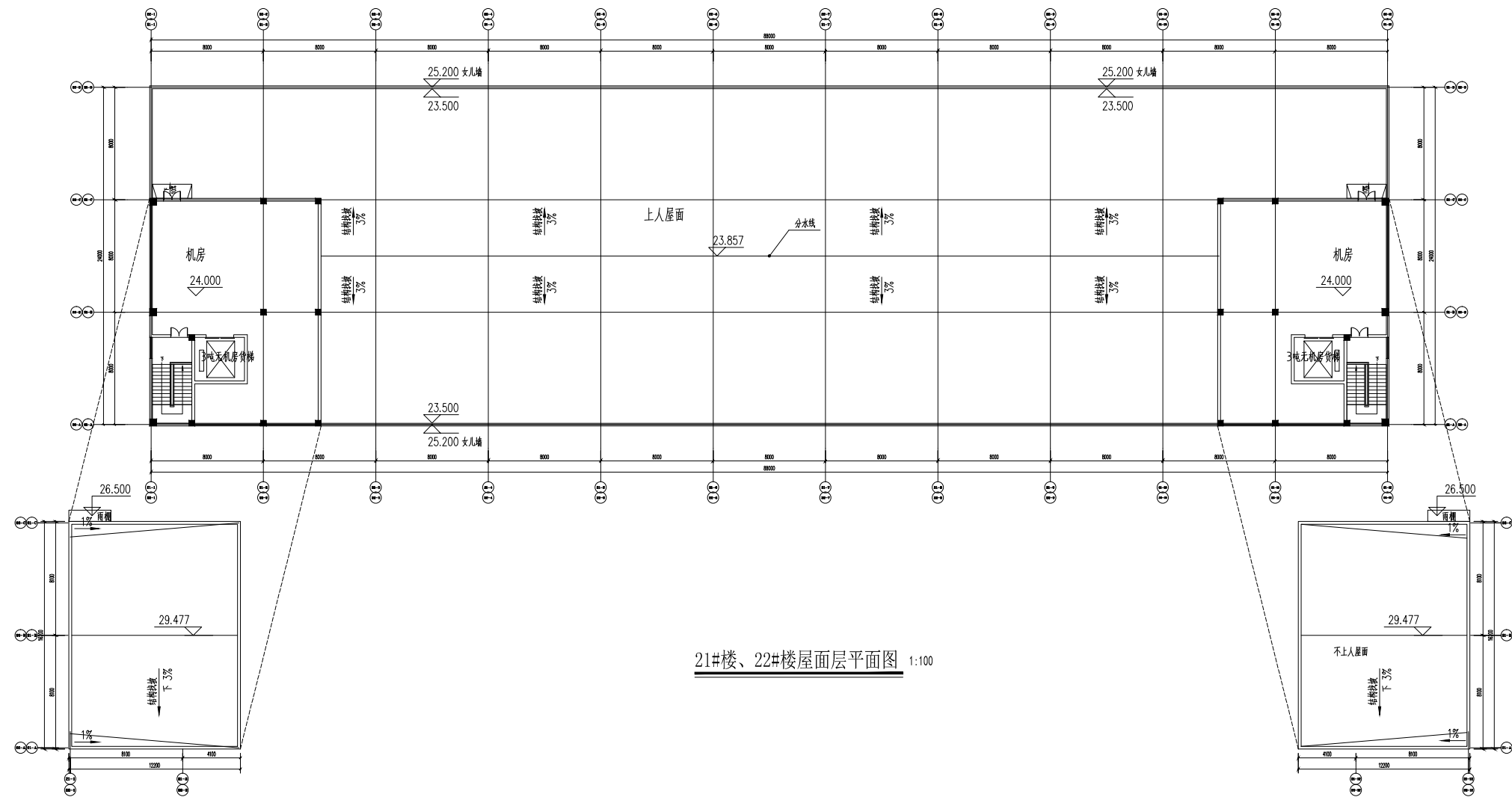

修改后

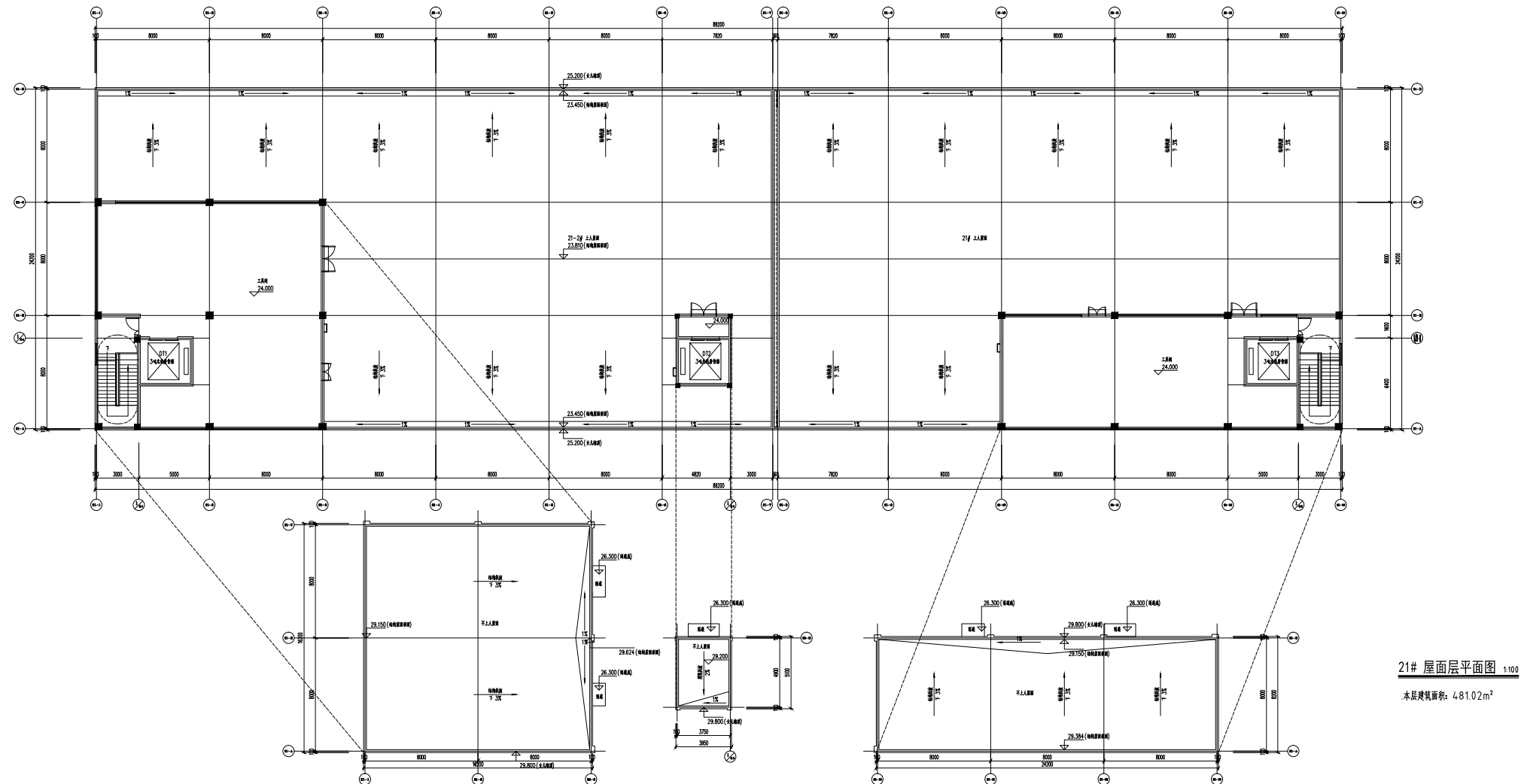

修改前

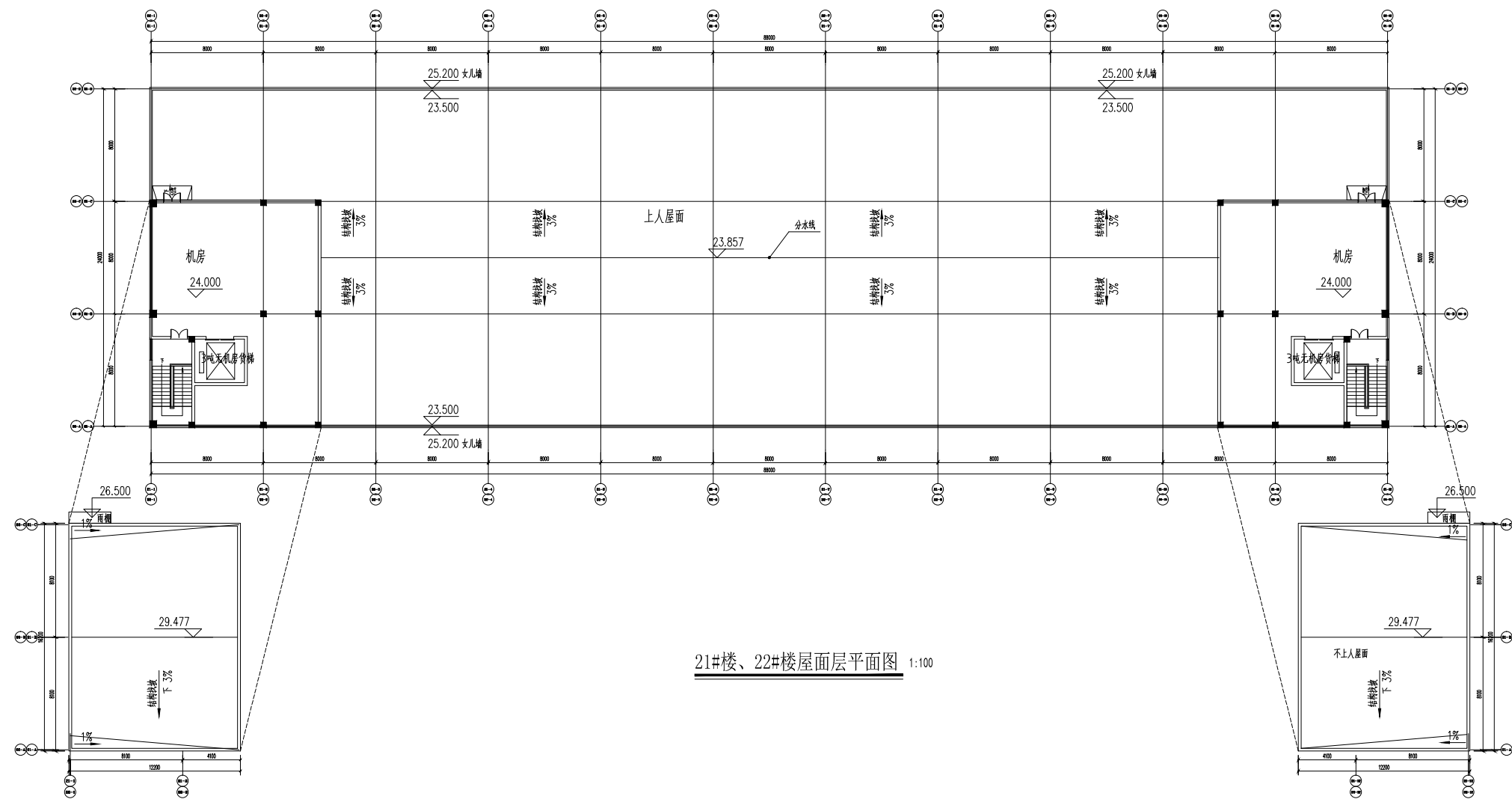

21#楼、22#楼屋面层平面图 1:100

修改后

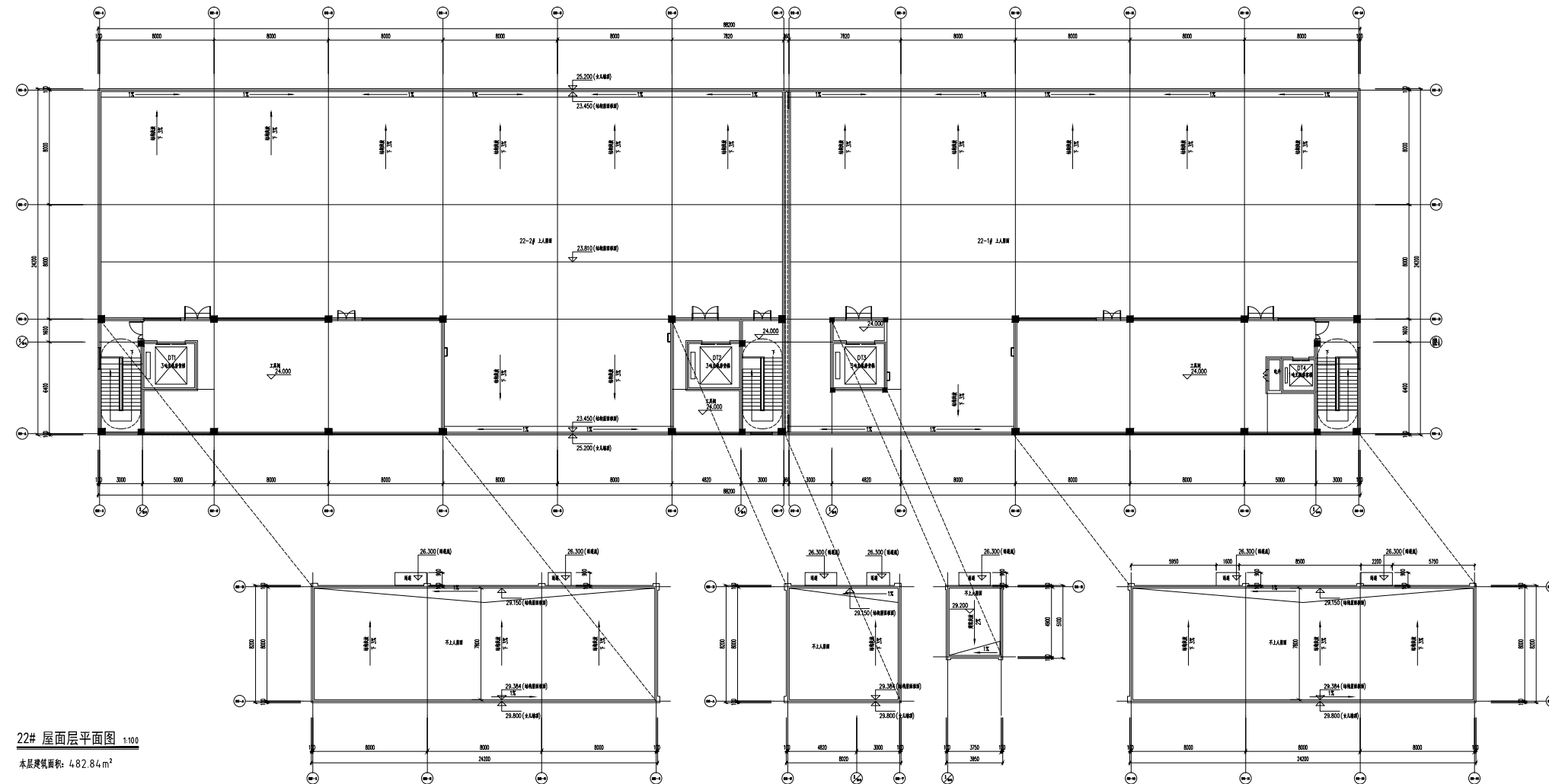

22# 屋面层平面图 1:100
本层建筑面积: 482.84m²